

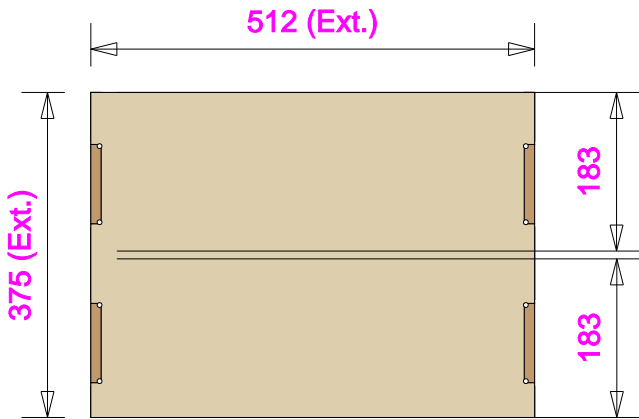

**Part No**  
94655-1

**Drawn By**  
Andy L

**Plan**



**Underside**

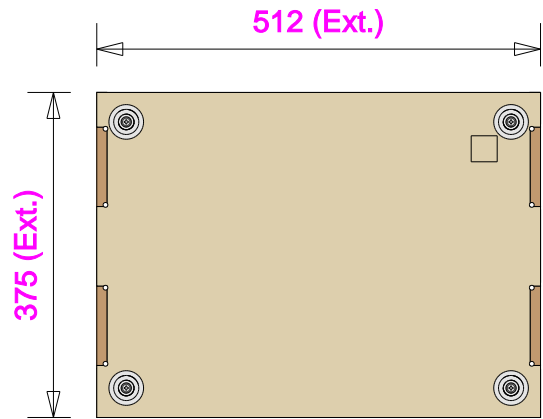

**Left**

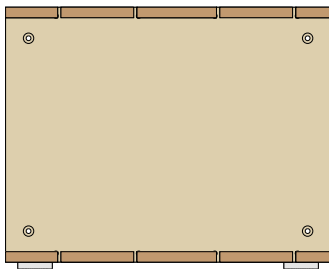

**Rack pitches.**

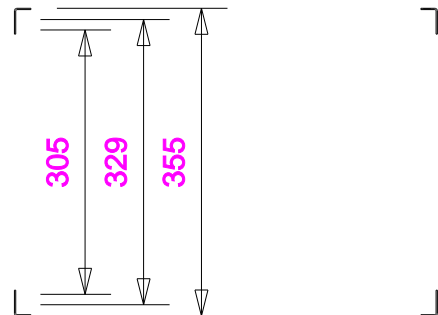



**Part No**  
94655-1

**Drawn By**  
Andy L

Right

Available rackstrip insets :  
10mm, 23mm & 35mm

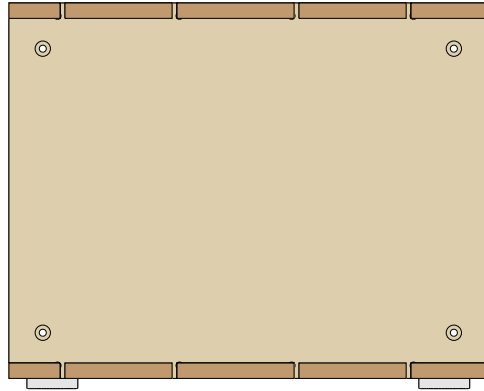
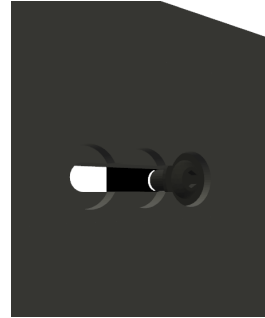

Hinged rear top panel

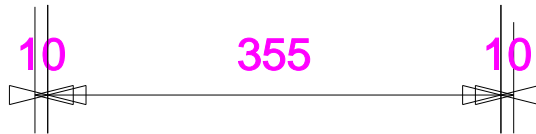

Front

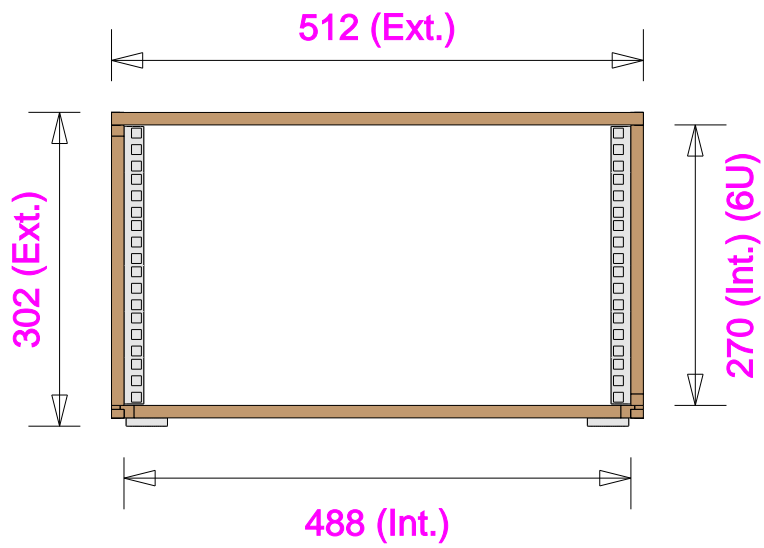

Rackstrip positions



**Part No**  
94655-1

**Drawn By**  
Andy L

Rack Strip Set in From FRONT 10mm  
Rack Strip Set in From REAR 10mm

